

INFO@ALUMARCH.COM
888 589 9771

KNOTWOOD SOFFIT SYSTEM

Description	Quantity	Unit
01. VENTED CLADDING BOARD (KECV150)	2,862	sf
02. STARTER (KEDSTRADJ)	278.91	ft
03. TOP CLIP LARGE & BASE (KECFBF)	652.42	ft
TOTAL FOR ALL SOFFIT SYSTEM		

- 01. VENTED CLADDING BOARD (KECV150)**
2,862sqft + 5% = 3,005sqft, 9.25ft per piece = 325 pieces
- 02. STARTER (KEDSTRADJ)**
278ft + 10% = 305ft, 18.5ft per piece = 17 pieces
- 03. TOP CLIP LARGE & BASE (KECFBF)**
652ft + 10% = 717ft, 18.5ft per piece = 39 pieces
- 04. TOP JOINER & BASE (KECJBF)**
08 pieces
- 05. CLADDING CLIP (KAOCC45)**
2,862sqft = 29 pieces (Bag of 100)

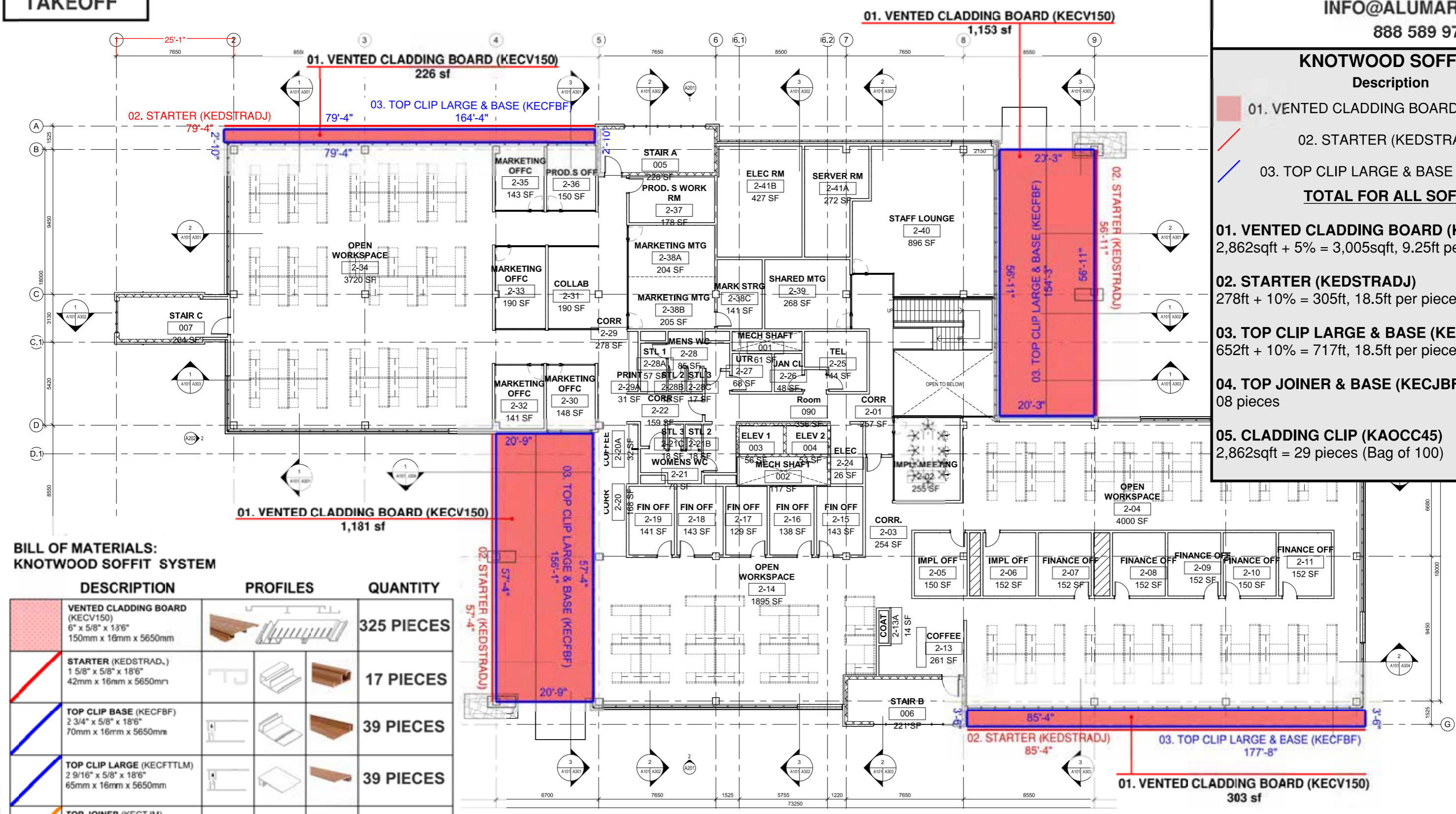

**BILL OF MATERIALS:
KNOTWOOD SOFFIT SYSTEM**

DESCRIPTION	PROFILES	QUANTITY
VENTED CLADDING BOARD (KECV150) 6" x 5/8" x 13/16" 150mm x 16mm x 5650mm		325 PIECES
STARTER (KEDSTRADJ) 1 5/8" x 5/8" x 18/16" 42mm x 16mm x 5650mm		17 PIECES
TOP CLIP BASE (KECFBF) 2 3/4" x 5/8" x 18/16" 70mm x 16mm x 5650mm		39 PIECES
TOP CLIP LARGE (KECFBFLM) 2 9/16" x 5/8" x 18/16" 65mm x 16mm x 5650mm		39 PIECES
TOP JOINER (KECTJM) 2" x 5/8" x 18/16" 50mm x 16mm x 5650mm		08 PIECES
TOP JOINER BASE (KECJBF) 4" x 5/8" x 18/16" 100mm x 16mm x 5650mm		08 PIECES
CLADDING CLIP (KAOCC45) 1 1/2" x 5/8" 38mm x 16mm		29 PIECES

PLEASE NOTE THAT:

- THIS TAKEOFF AND QUANTITIES CALCULATED ARE A COMPLIMENTARY SERVICE FROM ALUMARCH. IT'S THE SOLE RESPONSIBILITY OF THE PURCHASER TO ENSURE QUANTITIES ARE CORRECT.
- THIS TAKEOFF HAS BEEN CALCULATED ON A SQUARE FOOTAGE BASIS. IN SOME AREAS, BUTT JOINTS MAY BE REQUIRED.

